



# PetroProof SP15/20

## Hose Pumps for Hydrocarbons

### Features and Benefits

- *Highly suitable for:*
  - hydrocarbons, oils, solvents, acids and bases
  - shear sensitive products
  - viscous products
  - abrasive and high density products
  - vacuum situations
- *Most suitable for handling shear sensitive products*
- *Accurate (+1%) dosing (metering) capabilities*
- *Smooth liquid passage without valves, dead corners or glands*
- *The material to be pumped does not contact mechanical parts or seals*
- *Easy maintenance, low cost, short down time*
- *Only one wearing part: the hose*
- *Easily and completely cleanable*
- *Easily adjustable and reversible rotation*
- *No metal contact or valves*
- *Safe for use in explosive environments*
- *No internal back flow (slip)*
- *Self priming to 95% vacuum*
- *One year comprehensive warranty*

### Performance Characteristics

PetroProof hose pump	15/20
Inner diameter pump hose [mm]	20
Capacity [gal/min]	0.63-2.38
Number of revolutions [rpm]	20-75
Starting torque [in-lbs]	2650
Running torque @72.5psi [in-lbs]	345

Standard configuration is geared at 49.2 rpm with 2 Hp motor.  
 Consult Watson-Marlow Bredel for alternative configurations.

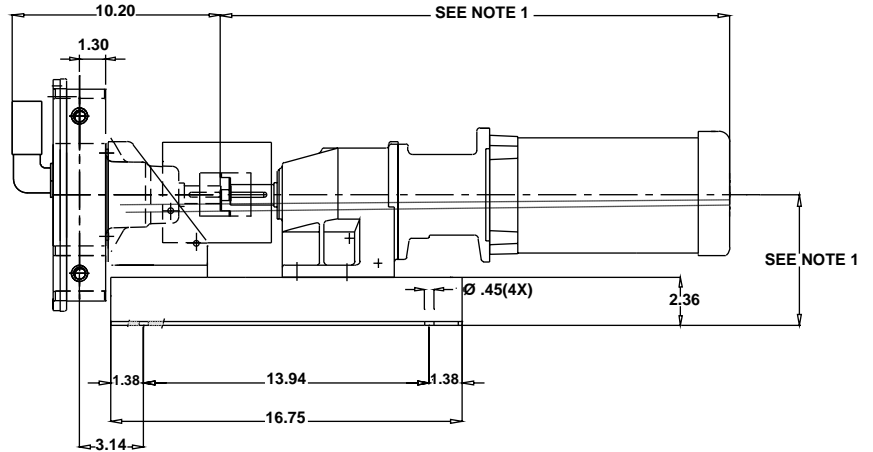
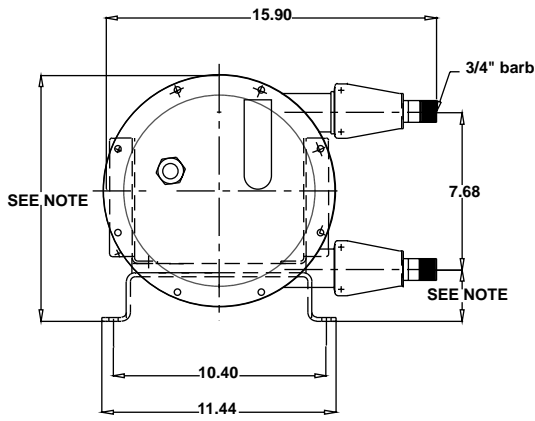

**Notes:**

1. Dimension is dependent on selection of gearbox and/or motor
2. All Dimensions in inches

# PetroProof SP15/20 Hose Pumps for Hydrocarbons

## **Technical Specifications**

**Displacement:** SP15/20 0.032 gal/rev  
**Supply:** 115/230 VAC 1-phase or  
 230/460 or 575 VAC 3-phase  
**Operating Speeds:** up to 75 rpm  
**Fluid Temperature Range\*:** 14° to 104°F  
**Ambient Temperature Range\*\*:** -4° to 113°F  
**Hose Lubricant Required:** 0.13 gallons  
**Flow Range:** up to 2.38 gpm  
**Discharge Pressure:** up to 72.5 psi  
**Suction Pressure:** 28 ft. lift to 30 psi  
**Available Hose Materials:** PetroProof  
**Available Insert Materials:** 316SS  
**Fittings:** 3/4" SS hose barb

## **Materials of Construction**

**Pumphead:** Cast iron  
**Rotor/Shoes:** Cast iron  
**Cover:** Cast iron  
**Flanges and Flange Brackets:** Galvanized steel  
**Frame:** 304SS  
**Hardware:** Galvanized steel or 304SS  
**Shaft:** Alloy steel  
**Seals:** NBR  
**Coupling Guard:** 304SS  
**Pumphead Weight:** 43 lbs  
**Estimated Assembly Weight:** 175 lbs

\*Consult Watson-Marlow Bredel for lower or higher temperature operation

\*\*Allowable ambient temperature is based on pump capabilities and may be further limited by gearmotor ambient capabilities.

The information contained in this document is believed to be correct, but Watson-Marlow Bredel Pumps accepts no liability for any errors it contains, and reserves the right to alter specifications without notice.

### **Watson-Marlow Bredel Pumps**

37 UPTON TECHNOLOGY PARK, WILMINGTON, MA 01887-1018  
 TEL: 800-282-8823, 978-658-6168 / FAX: 978-658-0041  
<http://www.watson-marlow.com>